

APPLICATION GUIDELINE

Document #: AG 16-001

Date of Release: December 2016

Ford Transit 350 HD Dual wheel

Application guideline for Alcoa wheel P/N 26180x 16x6J forged aluminum dual wheel and Accessory P/N 139699 2-piece sleeved flange nut

Alcoa Wheel P/N 26180x 16x6J forged aluminum dual wheel for use on the Ford Transit 350HD chassis was introduced in 2016. This application guideline covers the proper installation and use of the mounting hardware necessary for Alcoa Wheel P/N 26180x.

Alcoa Wheel accessory 2-piece sleeved flange nut P/N 139699 was developed exclusively for use with Alcoa P/N 26180x 16x6J forged aluminum wheel on the Ford Transit 350HD dual wheel chassis (both steer and dual wheel positions require the use of this nut). The P/N 139699 2-piece sleeved flange nut is designed to have more thread engagement than the standard OEM 2-piece flange nut. This is achieved by the addition of threads in the sleeved portion of the nut as shown in Figure 1. The shank or sleeve of these nuts extends into the (larger diameter) mounting holes and compensates the standard stud length securing sufficient thread engagement. (All threads in the sleeve do not need to be engaged with the wheel bolt for proper installation as noted in the Service Manual for Alcoa Wheels).

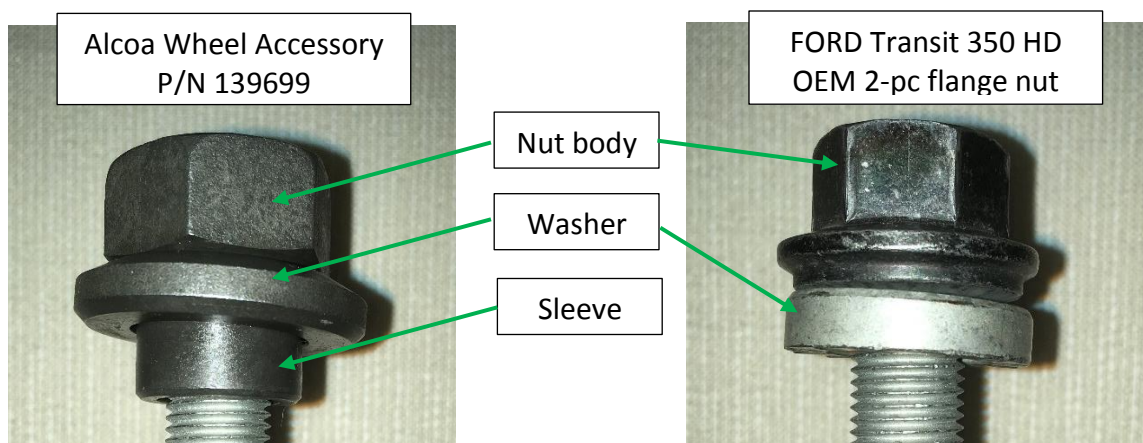
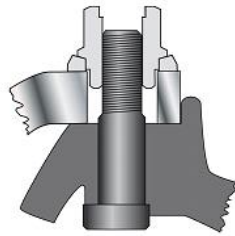

Figure 1 - The difference between the Alcoa wheel accessory 2-piece sleeved flange nut and the standard OEM accessory 2-piece flange nut. Photos credit from Arconic Wheel and Transportation Products



Photos credit from Arconic Wheel and Transportation Products

Figure 2 – Proper front wheel assembly



P/N 26180x

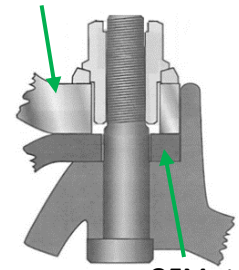

OEM steel wheel

Figure 3 - Proper rear dual assembly showing inner steel wheel and outer Aluminum

The proper front and rear wheel setup when using Alcoa Wheel P/N 26180x is shown in Figures 2 and 3 above. In the rear application, the inner dual wheel **must** be the Ford original equipment steel wheel with Alcoa Wheel P/N 26180x in the outer dual wheel position. This setup should provide both proper stud engagement and pilot engagement when used on the Ford original equipment hub and studs.

Proper Installation and Use

Rotate the hub so that one pilot is at the 12 o'clock position. Then, position one of the lug holes above that pilot as shown below. After positioning wheels on the pilot, hand tighten all two-piece sleeved flange nuts, then tighten to the OEM recommended torque (reference Ford Transit Owner's Manual for applicable model year vehicle) following the proper sequence shown in Figure 4.

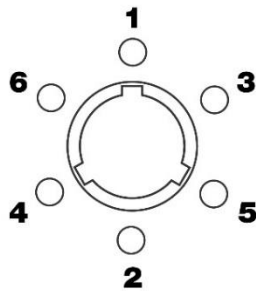

Figure 4 – Recommended torque sequence for the 6-hole Alcoa wheel P/N 26180x 16x6J forged aluminum dual wheel (also example of typical torque wrench). Photo credit from Arconic Wheel and Transportation Products

After 5-100 miles of operation, torque should be rechecked, unless your documented fleet practices determine otherwise. Check torque frequently from then on.

Nuts must be kept tight, and studs and nuts should be checked frequently.

Impact wrenches, if used, should be carefully adjusted to apply torques within the OEM recommended limits. Torquing of nuts should be done in the recommended sequence.

After each wheel mounting, nut torque should be checked with a torque wrench. Nuts should be re-torqued if necessary.

At tire changes, nuts and studs should be inspected to be sure they are in good condition. If a nut is found cracked or has stripped or damaged threads, remove these nuts from service. Check wheel studs accordingly. If replacement of the nuts is required only use Alcoa Wheels accessory P/N 139699 2-piece sleeved flange nuts. If replacement of any other wheel end components is necessary, it is recommended to use OEM parts.

For further information on proper wheel installation and maintenance practices, please refer to the Service Manual for Alcoa Wheels.

Accessories

Hub cap covers and flange nut covers developed for use with Alcoa Wheel P/N 26180x are shown below.

- 1) Front or rear hub cap - P/N 023320
- 2) Nut cover – P/N 019001
- 3) Kit P/N 024019 includes:
 - a. 1pc - P/N 023320
 - b. 6pc – P/N 019001



If you have any questions please contact the Tech Service Center for Alcoa Wheels at (800) 242-9898 option 1.